

# ANNEXATIONS IN WEST LINN 1913-2005

PREPARED AUG. 2005

## QUICK FACTS

Current City Limits: 5,045 acres (7.9 sq. miles)  
Population: 24,979  
Number of Parcels in the City: 9,610  
Number of Residential Units in the City: 9,724

Infill outside the City, but in the UGB\*:  
Infill Parcels: 209 acres (100 properties)  
Number of Existing Residential Units: 64  
Vacant Infill Parcels: 79 acres (30 properties)  
Non-Vacant Infill Parcels: 116 acres (63 properties)  
City Owned Infill Parcels: 12 acres (6 properties)  
ODOT Owned Infill Parcels: 2 acres (1 property)  
Right-of-Way Infill: 4 acres (5 locations)  
How many are less than 2 acres? 65 properties  
UGB: 5,254 acres (8.2 sq. miles)  
Percent of UGB remaining outside City Limits: 4%

\*UGB noted includes Area 37 (2002 UGB)

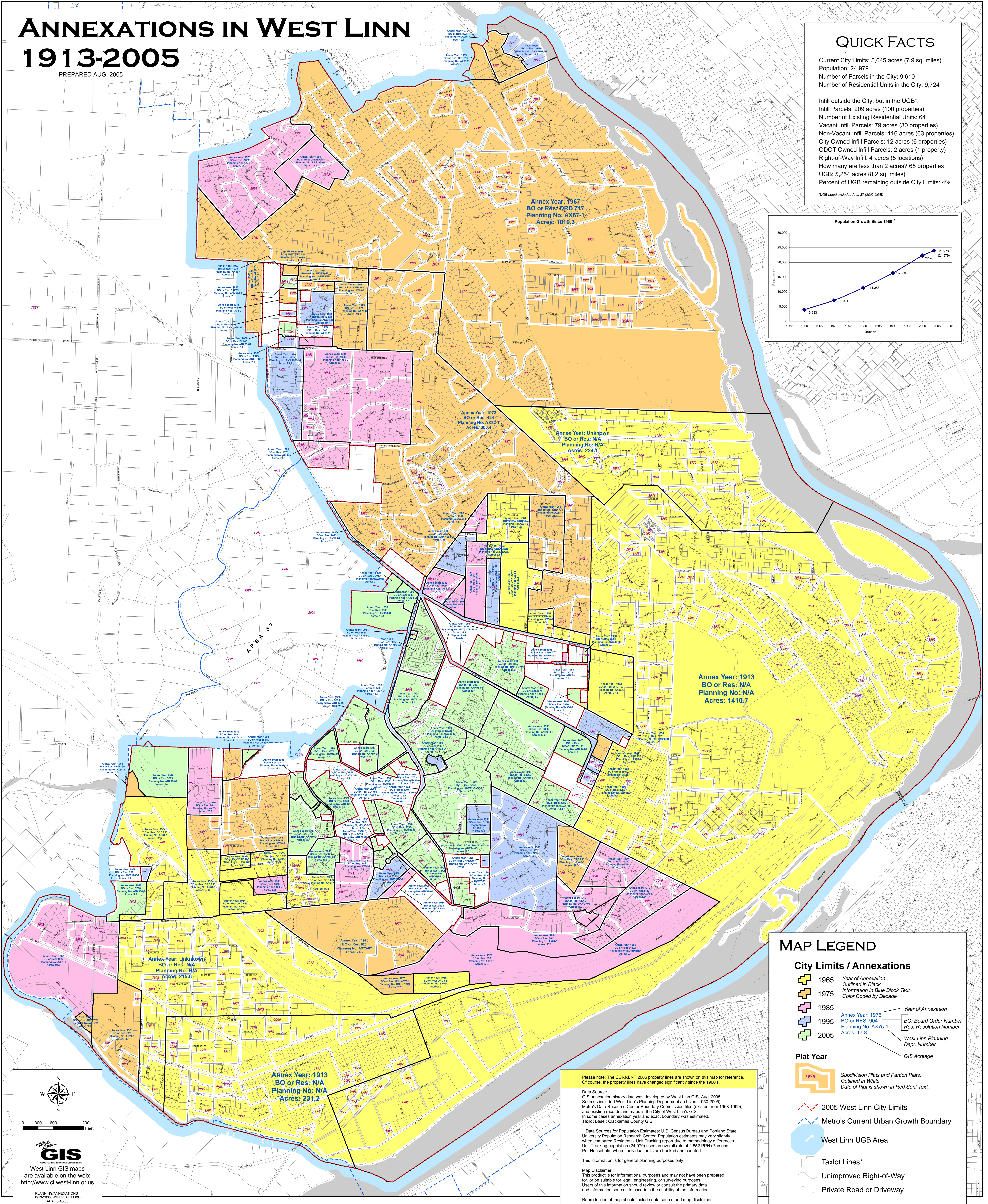
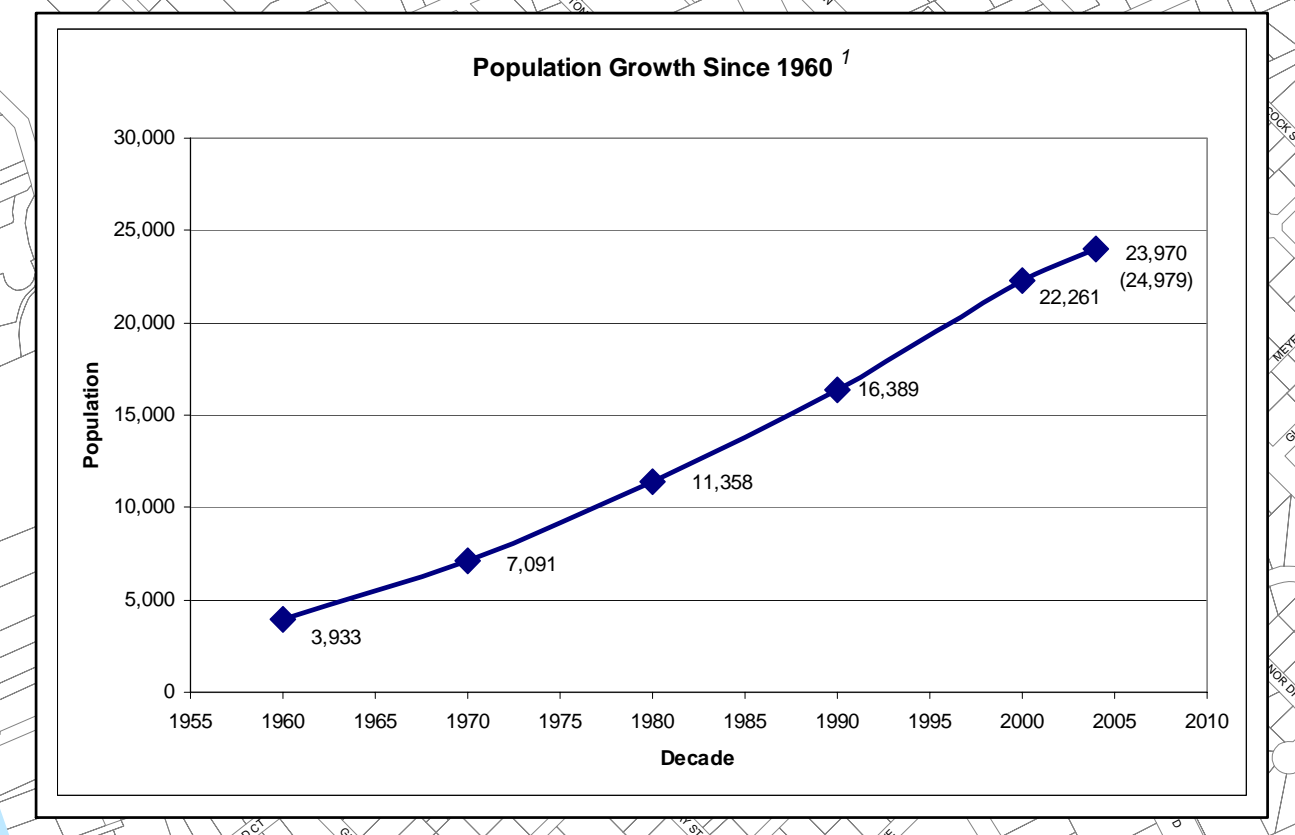

## MAP LEGEND

### City Limits / Annexations

- 1965 Year of Annexation Outlined in Black Information in Blue Block Text Color Coded by Decade
- 1975
- 1985
- 1995 Annex Year: 1976 BO or Res: 504 BO Board Order Number Res: Resolution Number Planning No: AX75-1 Res: Resolution Number West Linn Planning Dept. Number
- 2005 GIS Acreage

### Plat Year

- 1978 Subdivision Plats and Partion Plats. Outlined in White. Date of Plat is shown in Red Serif Text.

- 2005 West Linn City Limits
- Metro's Current Urban Growth Boundary
- West Linn UGB Area
- Taxlot Lines\*
- Unimproved Right-of-Way
- Private Road or Driveway

Please note: The CURRENT 2005 property lines are shown on this map for reference. Of course, the property lines have changed significantly since the 1960's.

Data Source: GIS annexation history data was developed by West Linn GIS, Aug. 2005. Sources included West Linn's Planning Department archives (1959-2005), Metro's Data Resource Center Boundary Commission files (1968-1999), and existing records and maps in the City of West Linn's GIS. In some cases annexation year and exact boundary was estimated.

Taxlot Bases: Clatsop County GIS. Data Sources for Population Estimates: U.S. Census Bureau and Portland State University Population Research Center. Population estimates may vary slightly when compared Residential Unit Tracking report due to methodology differences. Unit Tracking population (24,979) uses an overall rate of 2.562 (Persons Per Household) where individual units are tracked and counted.

This information is for general planning purposes only. Map Disclaimer: This product is for informational purposes and may not have been prepared for, or be suitable for, legal, engineering, or surveying purposes. Users of this information should review or consult the primary data and information sources to ascertain the usability of the information. Reproduction of map should include data source and map disclaimer.

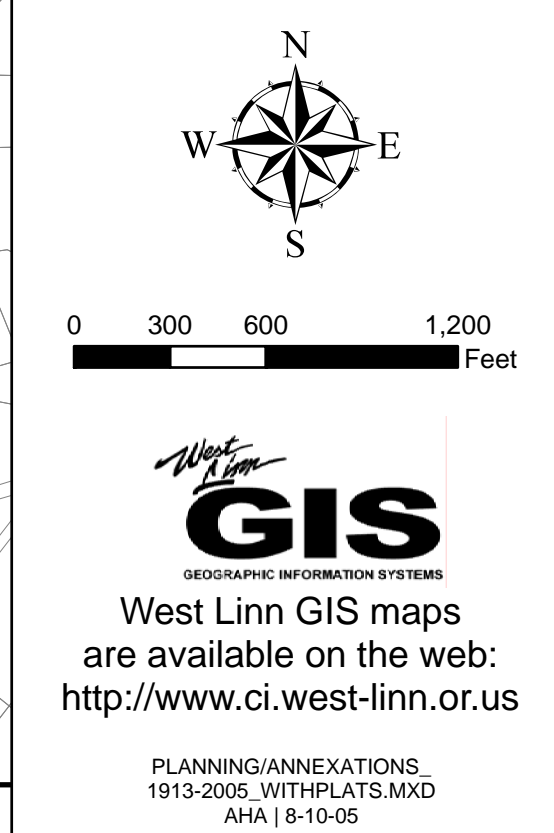

## 40 YEARS OF ANNEXATIONS BY DECADE:

